

* required information

Section 1 of 21

You can save the form at any time and resume it later. You do not need to be logged in when you resume.

System reference This is the unique reference for this application generated by the system.

Your reference You can put what you want here to help you track applications if you make lots of them. It is passed to the authority.

Are you an agent acting on behalf of the applicant?

- Yes No

Put "no" if you are applying on your own behalf or on behalf of a business you own or work for.

Applicant Details

* First name

* Family name

* E-mail

Main telephone number Include country code.

Other telephone number

Indicate here if you would prefer not to be contacted by telephone

Are you:

- Applying as a business or organisation, including as a sole trader
- Applying as an individual

A sole trader is a business owned by one person without any special legal structure. Applying as an individual means you are applying so you can be employed, or for some other personal reason, such as following a hobby.

Applicant Business

Is your business registered in the UK with Companies House? Yes No

Note: completing the Applicant Business section is optional in this form.

Registration number

Business name If your business is registered, use its registered name.

VAT number Put "none" if you are not registered for VAT.

Legal status

Continued from previous page...

Your position in the business

Home country

The country where the headquarters of your business is located.

Registered Address

Address registered with Companies House.

Building number or name

Street

District

City or town

County or administrative area

Postcode

Country

Section 2 of 21

PREMISES DETAILS

I/we, as named in section 1, apply for a premises licence under section 17 of the Licensing Act 2003 for the premises described in section 2 below (the premises) and I/we are making this application to you as the relevant licensing authority in accordance with section 12 of the Licensing Act 2003.

Premises Address

Are you able to provide a postal address, OS map reference or description of the premises?

Address OS map reference Description

Postal Address Of Premises

Building number or name

Street

District

City or town

County or administrative area

Postcode

Country

Further Details

Telephone number

Non-domestic rateable value of premises (£)

Section 3 of 21**APPLICATION DETAILS**

In what capacity are you applying for the premises licence?

- An individual or individuals
- A limited company / limited liability partnership
- A partnership (other than limited liability)
- An unincorporated association
- Other (for example a statutory corporation)
- A recognised club
- A charity
- The proprietor of an educational establishment
- A health service body
- A person who is registered under part 2 of the Care Standards Act 2000 (c14) in respect of an independent hospital in Wales
- A person who is registered under Chapter 2 of Part 1 of the Health and Social Care Act 2008 in respect of the carrying on of a regulated activity (within the meaning of that Part) in an independent hospital in England
- The chief officer of police of a police force in England and Wales

Confirm The Following

- I am carrying on or proposing to carry on a business which involves the use of the premises for licensable activities
- I am making the application pursuant to a statutory function
- I am making the application pursuant to a function discharged by virtue of Her Majesty's prerogative

Section 4 of 21**NON INDIVIDUAL APPLICANTS**

Provide name and registered address of applicant in full. Where appropriate give any registered number. In the case of a partnership or other joint venture (other than a body corporate), give the name and address of each party concerned.

Non Individual Applicant's Name

Name

Details

Registered number (where applicable)

Description of applicant (for example partnership, company, unincorporated association etc)

Continued from previous page...

Address

Building number or name

Street

District

City or town

County or administrative area

Postcode

Country

Contact Details

E-mail

Telephone number

Other telephone number

* Date of birth / /
dd mm yyyy

* Nationality Documents that demonstrate entitlement to work in the UK

Section 5 of 21

OPERATING SCHEDULE

When do you want the premises licence to start? / /
dd mm yyyy

If you wish the licence to be valid only for a limited period, when do you want it to end / /
dd mm yyyy

Provide a general description of the premises

For example the type of premises, its general situation and layout and any other information which could be relevant to the licensing objectives. Where your application includes off-supplies of alcohol and you intend to provide a place for consumption of these off- supplies you must include a description of where the place will be and its proximity to the premises.

WE ARE APPLYING A PREMISES LICENCE FOR A CHINESE RESTAURANT SITUATES AT 270-272 HIGH ROAD IN LOUGHTON IG10 1RB. THE NAME OF THE RESTAURANT IS WO FAT. WO FAT PROVIDES HOT FOODS FOR SIT IN CUSTOMERS AND ALSO HAVE TAKEAWAY SERVICES.

Continued from previous page...

If 5,000 or more people are expected to attend the premises at any one time, state the number expected to attend

50

Section 6 of 21

PROVISION OF PLAYS

See guidance on regulated entertainment

Will you be providing plays?

Yes

No

Section 7 of 21

PROVISION OF FILMS

See guidance on regulated entertainment

Will you be providing films?

Yes

No

Section 8 of 21

PROVISION OF INDOOR SPORTING EVENTS

See guidance on regulated entertainment

Will you be providing indoor sporting events?

Yes

No

Section 9 of 21

PROVISION OF BOXING OR WRESTLING ENTERTAINMENTS

See guidance on regulated entertainment

Will you be providing boxing or wrestling entertainments?

Yes

No

Section 10 of 21

PROVISION OF LIVE MUSIC

See guidance on regulated entertainment

Will you be providing live music?

Yes

No

Section 11 of 21

PROVISION OF RECORDED MUSIC

See guidance on regulated entertainment

Will you be providing recorded music?

Yes

No

Standard Days And Timings

Continued from previous page...

MONDAY

Start

End

Start

End

Give timings in 24 hour clock.
(e.g., 16:00) and only give details for the days
of the week when you intend the premises
to be used for the activity.

TUESDAY

Start

End

Start

End

WEDNESDAY

Start

End

Start

End

THURSDAY

Start

End

Start

End

FRIDAY

Start

End

Start

End

SATURDAY

Start

End

Start

End

SUNDAY

Start

End

Start

End

Will the playing of recorded music take place indoors or outdoors or both?

- Indoors Outdoors Both

Where taking place in a building or other
structure tick as appropriate. Indoors may
include a tent.

State type of activity to be authorised, if not already stated, and give relevant further details, for example (but not
exclusively) whether or not music will be amplified or unamplified.

WE WANT TO HAVE A CHINESE DRAGON DANCE PERFORMANCE ONCE A YEAR ROUGHLY END OF JANUARY OR BEGINNING
OF FEBRAURY FOR ABOUT HALF AN HOUR.
WE MAY ORGANISE A LIVE MUSIC NIGHT FOR EXAMPLE "ELVIS NIGHT " ONCE OR TWICE A YEAR. MUSIC WILL BE SLIGHTLY
AMPLIFIED.

State any seasonal variations for playing recorded music

For example (but not exclusively) where the activity will occur on additional days during the summer months.

NOT APPLY

Continued from previous page...

Non-standard timings. Where the premises will be used for the playing of recorded music at different times from those listed in the column on the left, list below

For example (but not exclusively), where you wish the activity to go on longer on a particular day e.g. Christmas Eve.

NOT APPLY

Section 12 of 21

PROVISION OF PERFORMANCES OF DANCE

See guidance on regulated entertainment

Will you be providing performances of dance?

Yes

No

Section 13 of 21

PROVISION OF ANYTHING OF A SIMILAR DESCRIPTION TO LIVE MUSIC, RECORDED MUSIC OR PERFORMANCES OF DANCE

See guidance on regulated entertainment

Will you be providing anything similar to live music, recorded music or performances of dance?

Yes

No

Section 14 of 21

LATE NIGHT REFRESHMENT

Will you be providing late night refreshment?

Yes

No

Standard Days And Timings

MONDAY

Start

End

Start

End

TUESDAY

Start

End

Start

End

WEDNESDAY

Start

End

Start

End

THURSDAY

Start

End

Start

End

Give timings in 24 hour clock. (e.g., 16:00) and only give details for the days of the week when you intend the premises to be used for the activity.

Continued from previous page...

FRIDAY

Start

End

Start

End

SATURDAY

Start

End

Start

End

SUNDAY

Start

End

Start

End

Will the provision of late night refreshment take place indoors or outdoors or both?

Indoors

Outdoors

Both

Where taking place in a building or other structure tick as appropriate. Indoors may include a tent.

State type of activity to be authorised, if not already stated, and give relevant further details, for example (but not exclusively) whether or not music will be amplified or unamplified.

SUPPLY NORMALLY RESTAURANT MEAL ONLY NO AMPLIFIED MUSIC,

State any seasonal variations

For example (but not exclusively) where the activity will occur on additional days during the summer months.

NA

Non-standard timings. Where the premises will be used for the supply of late night refreshments at different times from those listed in the column on the left, list below

For example (but not exclusively), where you wish the activity to go on longer on a particular day e.g. Christmas Eve.

NA

Section 15 of 21

SUPPLY OF ALCOHOL

Will you be selling or supplying alcohol?

Yes

No

Continued from previous page...

Standard Days And Timings

MONDAY

Start

End

Start

End

Give timings in 24 hour clock.
(e.g., 16:00) and only give details for the days
of the week when you intend the premises
to be used for the activity.

TUESDAY

Start

End

Start

End

WEDNESDAY

Start

End

Start

End

THURSDAY

Start

End

Start

End

FRIDAY

Start

End

Start

End

SATURDAY

Start

End

Start

End

SUNDAY

Start

End

Start

End

Will the sale of alcohol be for consumption:

- On the premises Off the premises Both

If the sale of alcohol is for consumption on
the premises select on, if the sale of alcohol
is for consumption away from the premises
select off. If the sale of alcohol is for
consumption on the premises and away
from the premises select both.

State any seasonal variations

For example (but not exclusively) where the activity will occur on additional days during the summer months.

NOT APPLY

Continued from previous page...

Non-standard timings. Where the premises will be used for the supply of alcohol at different times from those listed in the column on the left, list below

For example (but not exclusively), where you wish the activity to go on longer on a particular day e.g. Christmas Eve.

NOT APPLY

State the name and details of the individual whom you wish to specify on the licence as premises supervisor

Name

First name

Family name

Date of birth / /
dd mm yyyy

Enter the contact's address

Building number or name

Street

District

City or town

County or administrative area

Postcode

Country

Personal Licence number (if known)

Issuing licensing authority (if known)

PROPOSED DESIGNATED PREMISES SUPERVISOR CONSENT

How will the consent form of the proposed designated premises supervisor be supplied to the authority?

- Electronically, by the proposed designated premises supervisor
- As an attachment to this application

Reference number for consent form (if known)

If the consent form is already submitted, ask the proposed designated premises supervisor for its 'system reference' or 'your reference'.

Continued from previous page...

Section 16 of 21

ADULT ENTERTAINMENT

Highlight any adult entertainment or services, activities, or other entertainment or matters ancillary to the use of the premises that may give rise to concern in respect of children

Give information about anything intended to occur at the premises or ancillary to the use of the premises which may give rise to concern in respect of children, regardless of whether you intend children to have access to the premises, for example (but not exclusively) nudity or semi-nudity, films for restricted age groups etc gambling machines etc.

NOT APPLY

Section 17 of 21

HOURS PREMISES ARE OPEN TO THE PUBLIC

Standard Days And Timings

MONDAY

Start

End

Start

End

Give timings in 24 hour clock.
(e.g., 16:00) and only give details for the days
of the week when you intend the premises
to be used for the activity.

TUESDAY

Start

End

Start

End

WEDNESDAY

Start

End

Start

End

THURSDAY

Start

End

Start

End

FRIDAY

Start

End

Start

End

SATURDAY

Start

End

Start

End

SUNDAY

Start

End

Start

End

State any seasonal variations

Continued from previous page...

For example (but not exclusively) where the activity will occur on additional days during the summer months.

NOT APPLY

Non standard timings. Where you intend to use the premises to be open to the members and guests at different times from those listed in the column on the left, list below

For example (but not exclusively), where you wish the activity to go on longer on a particular day e.g. Christmas Eve.

NOT APPLY

Section 18 of 21

LICENSING OBJECTIVES

Describe the steps you intend to take to promote the four licensing objectives:

a) General – all four licensing objectives (b,c,d,e)

List here steps you will take to promote all four licensing objectives together.

WE WILL TRAIN ALL STAFFS WORKING IN THE RESTAURANT : DO NOT SELL ALCOHOLIC DRINK TO PERSON UNDER THE AGE OF 18 YEAR OLD. (REQUEST FOR ID IF IN DOUBT). DO NOT SELL ALCOHOLIC DRINK TO A PERSON APPEARS TO BE VERY DRUNK.

b) The prevention of crime and disorder

WE WILL INSTALL VIDEO/CCTV EQUIPMENT INSIDE AND OUTSIDE THE PREMISES AND ENSURE THAT IT IS MAINTAINED IN WORKING ORDER.
WE WILL SET VIDEO/CCTV EQUIPMENT TO RECORD 24 HOURS A DAY.

c) Public safety

WE WILL BE RESPONSIBLE FOR THE DISPOSAL OF WASTE ON THE FRONTAGE OF THE PREMISES.
WE WILL ENSURE THAT THE MAXIMUM OCCUPANCY OF THE LICENCE PREMISES IS RESTRICTED TO 80 PEOPLE AT ANY TIME.

d) The prevention of public nuisance

WE WILL ENSURE THAT THE CONSUMPTION OF ALCOHOL IS RESTRICTED TO THE RESTAURANTAREA (CUSTOMER SEATING) AS INDICATED ON THE GROUND FLOOR PLAN DRAWING.

e) The protection of children from harm

WE WILL ENSURE THAT ANY PERSON SELLING OR SUPPLYING ALCOHOLIC DRINK UNDER THE AUTHORITY OF A PERSONAL LICENCE HOLDER ASKS FOR A PHOTO ID PROOF OF AGE WHERE THEY HAVE REASON TO SUSPECT THAT THE INDIVIDUAL

Continued from previous page...

MAY BE UNDER 18 YEARS OF AGE.

Section 19 of 21

NOTES ON DEMONSTRATING ENTITLEMENT TO WORK IN THE UK

Entitlement to work/immigration status for individual applicants and applications from partnerships which are not limited liability partnerships:

A licence may not be held by an individual or an individual in a partnership who is resident in the UK who:

- does not have the right to live and work in the UK; or
- is subject to a condition preventing him or her from doing work relating to the carrying on of a licensable activity.

Any premises licence issued in respect of an application made on or after 6 April 2017 will become invalid if the holder ceases to be entitled to work in the UK.

Applicants must demonstrate that they have an entitlement to work in the UK and are not subject to a condition preventing them from doing work relating to the carrying on of a licensable activity. They do this in one of two ways: 1) by providing with this application copies or scanned copies of the documents listed below (which do not need to be certified), or 2) by providing their 'share code' to enable the licensing authority to carry out a check using the Home Office online right to work checking service (see below).

Documents which demonstrate entitlement to work in the UK

- An expired or current passport showing the holder, or a person named in the passport as the child of the holder, is a British citizen or a citizen of the UK and Colonies having the right of abode in the UK [please see note below about which sections of the passport to copy].
- An expired or current passport or national identity card showing the holder, or a person named in the passport as the child of the holder, is a national of a European Economic Area country or Switzerland.
- A Registration Certificate or document certifying permanent residence issued by the Home Office to a national of a European Economic Area country or Switzerland.
- A Permanent Residence Card issued by the Home Office to the family member of a national of a European Economic Area country or Switzerland.
- A **current** Biometric Immigration Document (Biometric Residence Permit) issued by the Home Office to the holder indicating that the person named is allowed to stay indefinitely in the UK, or has no time limit on their stay in the UK.
- A **current** passport endorsed to show that the holder is exempt from immigration control, is allowed to stay indefinitely in the UK, has the right of abode in the UK, or has no time limit on their stay in the UK.
- A **current** Immigration Status Document issued by the Home Office to the holder with an endorsement indicating that the named person is allowed to stay indefinitely in the UK or has no time limit on their stay in the UK, **when produced in combination with** an official document giving the person's permanent National Insurance number and their name issued by a Government agency or a previous employer.
- A birth or adoption certificate issued in the UK, **when produced in combination with** an official document giving the person's permanent National Insurance number and their name issued by a Government agency or a previous employer.
- A birth or adoption certificate issued in the Channel Islands, the Isle of Man or Ireland **when produced in combination with** an official document giving the person's permanent National Insurance number and their name issued by a Government agency or a previous employer.
- A certificate of registration or naturalisation as a British citizen, **when produced in combination with** an official document giving the person's permanent National Insurance number and their name issued by a Government agency or a previous employer.

Continued from previous page...

- A **current** passport endorsed to show that the holder is allowed to stay in the UK and is currently allowed to work and is not subject to a condition preventing the holder from doing work relating to the carrying on of a licensable activity.
- A **current** Biometric Immigration Document (Biometric Residence Permit) issued by the Home Office to the holder which indicates that the named person can currently stay in the UK and is allowed to work relation to the carrying on of a licensable activity.
- A **current** Residence Card issued by the Home Office to a person who is not a national of a European Economic Area state or Switzerland but who is a family member of such a national or who has derivative rights or residence.
- A **current** Immigration Status Document containing a photograph issued by the Home Office to the holder with an endorsement indicating that the named person may stay in the UK, and is allowed to work and is not subject to a condition preventing the holder from doing work relating to the carrying on of a licensable activity **when produced in combination with** an official document giving the person's permanent National Insurance number and their name issued by a Government agency or a previous employer.
- A Certificate of Application, **less than 6 months old**, issued by the Home Office under regulation 18(3) or 20(2) of the Immigration (European Economic Area) Regulations 2016, to a person who is not a national of a European Economic Area state or Switzerland but who is a family member of such a national or who has derivative rights of residence.
- Reasonable evidence that the person has an outstanding application to vary their permission to be in the UK with the Home Office such as the Home Office acknowledgement letter or proof of postage evidence, or reasonable evidence that the person has an appeal or administrative review pending on an immigration decision, such as an appeal or administrative review reference number.
- Reasonable evidence that a person who is not a national of a European Economic Area state or Switzerland but who is a family member of such a national or who has derivative rights of residence in exercising treaty rights in the UK including:-
 - evidence of the applicant's own identity – such as a passport,
 - evidence of their relationship with the European Economic Area family member – e.g. a marriage certificate, civil partnership certificate or birth certificate, and
 - evidence that the European Economic Area national has a right of permanent residence in the UK or is one of the following if they have been in the UK for more than 3 months:
 - (i) working e.g. employment contract, wage slips, letter from the employer,
 - (ii) self-employed e.g. contracts, invoices, or audited accounts with a bank,
 - (iii) studying e.g. letter from the school, college or university and evidence of sufficient funds; or
 - (iv) self-sufficient e.g. bank statements.

Family members of European Economic Area nationals who are studying or financially independent must also provide evidence that the European Economic Area national and any family members hold comprehensive sickness insurance in the UK. This can include a private medical insurance policy, an EHIC card or an S1, S2 or S3 form.

Original documents must not be sent to licensing authorities. If the document copied is a passport, a copy of the following pages should be provided:-

- (i) any page containing the holder's personal details including nationality;
- (ii) any page containing the holder's photograph;
- (iii) any page containing the holder's signature;
- (iv) any page containing the date of expiry; and
- (v) any page containing information indicating the holder has permission to enter or remain in the UK and is permitted to work.

Continued from previous page...

If the document is not a passport, a copy of the whole document should be provided.

Your right to work will be checked as part of your licensing application and this could involve us checking your immigration status with the Home Office. We may otherwise share information with the Home Office. Your licence application will not be determined until you have complied with this guidance.

Home Office online right to work checking service

As an alternative to providing a copy of the documents listed above, applicants may demonstrate their right to work by allowing the licensing authority to carry out a check with the Home Office online right to work checking service.

To demonstrate their right to work via the Home Office online right to work checking service, applicants should include in this application their 9-digit share code (provided to them upon accessing the service at <https://www.gov.uk/prove-right-to-work>) which, along with the applicant's date of birth (provided within this application), will allow the licensing authority to carry out the check.

In order to establish the applicant's right to work, the check will need to indicate that the applicant is allowed to work in the United Kingdom and is not subject to a condition preventing them from doing work relating to the carrying on of a licensable activity.

An online check will not be possible in all circumstances because not all applicants will have an immigration status that can be checked online. The Home Office online right to work checking service sets out what information and/or documentation applicants will need in order to access the service. Applicants who are unable to obtain a share code from the service should submit copy documents as set out above.

Section 20 of 21

NOTES ON REGULATED ENTERTAINMENT

Continued from previous page...

In terms of specific **regulated entertainments** please note that:

- **Plays:** no licence is required for performances between 08:00 and 23.00 on any day, provided that the audience does not exceed 500.
- **Films:** no licence is required for 'not-for-profit' film exhibition held in community premises between 08.00 and 23.00 on any day provided that the audience does not exceed 500 and the organiser (a) gets consent to the screening from a person who is responsible for the premises; and (b) ensures that each such screening abides by age classification ratings.
- **Indoor sporting events:** no licence is required for performances between 08.00 and 23.00 on any day, provided that the audience does not exceed 1000.
- **Boxing or Wrestling Entertainment:** no licence is required for a contest, exhibition or display of Greco-Roman wrestling, or freestyle wrestling between 08.00 and 23.00 on any day, provided that the audience does not exceed 1000. Combined fighting sports – defined as a contest, exhibition or display which combines boxing or wrestling with one or more martial arts – are licensable as a boxing or wrestling entertainment rather than an indoor sporting event.
- **Live music:** no licence permission is required for:
 - o a performance of unamplified live music between 08.00 and 23.00 on any day, on any premises.
 - o a performance of amplified live music between 08.00 and 23.00 on any day on premises authorised to sell alcohol for consumption on those premises, provided that the audience does not exceed 500.
 - o a performance of amplified live music between 08.00 and 23.00 on any day, in a workplace that is not licensed to sell alcohol on those premises, provided that the audience does not exceed 500.
 - o a performance of amplified live music between 08.00 and 23.00 on any day, in a church hall, village hall, community hall, or other similar community premises, that is not licensed by a premises licence to sell alcohol, provided that (a) the audience does not exceed 500, and (b) the organiser gets consent for the performance from a person who is responsible for the premises.
 - o a performance of amplified live music between 08.00 and 23.00 on any day, at the non-residential premises of (i) a local authority, or (ii) a school, or (iii) a hospital, provided that (a) the audience does not exceed 500, and (b) the organiser gets consent for the performance on the relevant premises from: (i) the local authority concerned, or (ii) the school or (iii) the health care provider for the hospital.
- **Recorded Music:** no licence permission is required for:
 - o any playing of recorded music between 08.00 and 23.00 on any day on premises authorised to sell alcohol for consumption on those premises, provided that the audience does not exceed 500.
 - o any playing of recorded music between 08.00 and 23.00 on any day, in a church hall, village hall, community hall, or other similar community premises, that is not licensed by a premises licence to sell alcohol, provided that (a) the audience does not exceed 500, and (b) the organiser gets consent for the performance from a person who is responsible for the premises.
 - o any playing of recorded music between 08.00 and 23.00 on any day, at the non-residential premises of (i) a local authority, or (ii) a school, or (iii) a hospital, provided that (a) the audience does not exceed 500, and (b) the organiser gets consent for the performance on the relevant premises from: (i) the local authority concerned, or (ii) the school proprietor or (iii) the health care provider for the hospital.

Continued from previous page...

- Dance: no licence is required for performances between 08.00 and 23.00 on any day, provided that the audience does not exceed 500. However, a performance which amounts to adult entertainment remains licensable.
- Cross activity exemptions: no licence is required between 08.00 and 23.00 on any day, with no limit on audience size for:
 - o any entertainment taking place on the premises of the local authority where the entertainment is provided by or on behalf of the local authority;
 - o any entertainment taking place on the hospital premises of the health care provider where the entertainment is provided by or on behalf of the health care provider;
 - o any entertainment taking place on the premises of the school where the entertainment is provided by or on behalf of the school proprietor; and
 - o any entertainment (excluding films and a boxing or wrestling entertainment) taking place at a travelling circus, provided that (a) it takes place within a moveable structure that accommodates the audience, and (b) that the travelling circus has not been located on the same site for more than 28 consecutive days.

Section 21 of 21

PAYMENT DETAILS

This fee must be paid to the authority. If you complete the application online, you must pay it by debit or credit card.

Premises Licence Fees are determined by the non-domestic rateable value of the premises.

To find out a premises non domestic rateable value go to the Valuation Office Agency site at http://www.voa.gov.uk/business_rates/index.htm

Band A - No RV to £4300 £100.00

Band B - £4301 to £33000 £190.00

Band C - £33001 to £8700 £315.00

Band D - £87001 to £12500 £450.00*

Band E - £125001 and over £635.00*

*If the premises rateable value is in Bands D or E and the premises is primarily used for the consumption of alcohol on the premises then you are required to pay a higher fee

Band D - £87001 to £12500 £900.00

Band E - £125001 and over £1,905.00

There is an exemption from the payment of fees in relation to the provision of regulated entertainment at church halls, chapel halls or premises of a similar nature, village halls, parish or community halls, or other premises of a similar nature. The costs associated with these licences will be met by central Government. If, however, the licence also authorises the use of the premises for the supply of alcohol or the provision of late night refreshment, a fee will be required.

Schools and sixth form colleges are exempt from the fees associated with the authorisation of regulated entertainment where the entertainment is provided by and at the school or college and for the purposes of the school or college.

If you operate a large event you are subject to ADDITIONAL fees based upon the number in attendance at any one time

Capacity 5000-9999 £1,000.00

Capacity 10000 -14999 £2,000.00

Capacity 15000-19999 £4,000.00

Capacity 20000-29999 £8,000.00

Capacity 30000-39000 £16,000.00

Capacity 40000-49999 £24,000.00

Capacity 50000-59999 £32,000.00

Capacity 60000-69999 £40,000.00

Capacity 70000-79999 £48,000.00

Capacity 80000-89999 £56,000.00

Capacity 90000 and over £64,000.00

* Fee amount (£)

315.00

ATTACHMENTS

AUTHORITY POSTAL ADDRESS

Continued from previous page...

Address

Building number or name	<input type="text"/>
Street	<input type="text"/>
District	<input type="text"/>
City or town	<input type="text"/>
County or administrative area	<input type="text"/>
Postcode	<input type="text"/>
Country	<input type="text" value="United Kingdom"/>

DECLARATION

[Applicable to individual applicants only, including those in a partnership which is not a limited liability partnership] I understand I am not entitled to be issued with a licence if I do not have the entitlement to live and work in the UK (or if I am subject to a condition preventing me from doing work relating to the carrying on of a licensable activity) and that my licence will become invalid if I cease to be entitled to live and work in the UK. The DPS named in this application form is entitled to work in the UK (and is not subject to conditions preventing him or her from doing work relating to a licensable activity) and I have seen a copy of his or her proof of entitlement to work, if appropriate

Ticking this box indicates you have read and understood the above declaration

This section should be completed by the applicant, unless you answered "Yes" to the question "Are you an agent acting on behalf of the applicant?"

* Full name	<input type="text"/>
* Capacity	<input type="text"/>
Date (dd/mm/yyyy)	<input type="text"/>

Once you're finished you need to do the following:

1. Save this form to your computer by clicking file/save as...
2. Go back to <https://www.gov.uk/apply-for-a-licence/premises-licence/epping-forest/apply-1> to upload this file and continue with your application.

Don't forget to make sure you have all your supporting documentation to hand.

IT IS AN OFFENCE LIABLE TO SUMMARY CONVICTION TO A FINE OF ANY AMOUNT UNDER SECTION 158 OF THE LICENSING ACT 2003, TO MAKE A FALSE STATEMENT IN OR IN CONNECTION WITH THIS APPLICATION

IT IS AN OFFENCE UNDER SECTION 24B OF THE IMMIGRATION ACT 1971 FOR A PERSON TO WORK WHEN THEY KNOW, OR HAVE REASONABLE CAUSE TO BELIEVE, THAT THEY ARE DISQUALIFIED FROM DOING SO BY REASON OF THEIR IMMIGRATION STATUS. THOSE WHO EMPLOY AN ADULT WITHOUT LEAVE OR WHO IS SUBJECT TO CONDITIONS AS TO EMPLOYMENT WILL BE LIABLE TO A CIVIL PENALTY UNDER SECTION 15 OF THE IMMIGRATION, ASYLUM AND NATIONALITY ACT 2006 AND PURSUANT TO SECTION 21 OF THE SAME ACT, WILL BE COMMITTING AN OFFENCE WHERE THEY DO SO IN THE KNOWLEDGE, OR WITH REASONABLE CAUSE TO BELIEVE, THAT THE EMPLOYEE IS DISQUALIFIED

Consent of individual to being specified as premises supervisor

_____ CAROL WONG

.....
[full name of prospective premises supervisor]

Of ██████ HIGH ROAD, LOUGHTON, ESSEX, IG10 1RB.

.....
[home address of prospective premises supervisor]

hereby confirm that I give my consent to be specified as the designated premises supervisor in relation to the application for

PREMISES LICENCE

.....
[type of application]

By JIALIN WEI

.....
[name of applicant]

relating to a premises licence

.....
[number of existing licence, if any]

for WO FAT RESTAURANT

270 – 272, HIGH ROAD, LOUGHTON, ESSEX, IG10 1RB.

.....
[name and address of premises to which the application relates]

and any premises licence to be granted or varied in respect of this application made by

JIALIN WEI

[name of applicant]

concerning the supply of alcohol at

WO FAT RESTAURANT, 270 – 272, HIGH ROAD LOUGHTON
ESSEX, IG10 1RB.

[name and address of premises to which application relates]

I also confirm that I am entitled to work in the United Kingdom and am applying for, intend to apply for or currently hold a personal licence, details of which I set out below.

Personal licence number

2285883

[insert personal licence number, if any]

Personal licence issuing authority

Reigate and Banstead Borough Council

[insert name and address and telephone number of personal licence issuing authority, if any]

Signed

CAR

Name (please print)

CAROL WONG

Date

08-05-2019

LEGEND

— Restaurant area

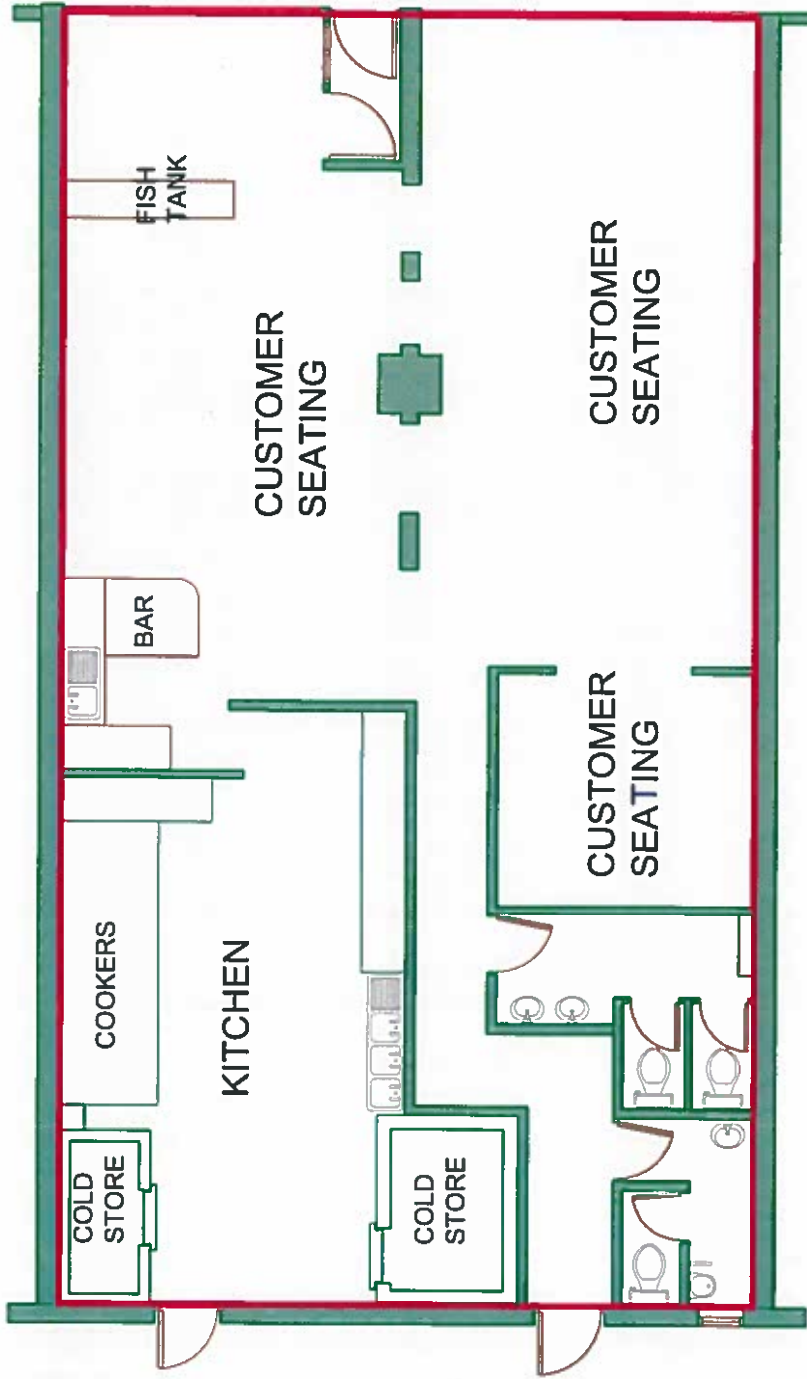

1:100 GROUND FLOOR PLAN

B	Restaurant Area defined	16.05.2019	
A	Customer Area shown	16.05.2019	
Rev	By	Description	Date

Client: **Wo Fat Restaurant**

Project: **Wo Fat Restaurant,
270-272 High Road,
Loughton, IG10 1RB**

Task: **Existing ground floor layout**

Date: **04.2019** Scale: **A4 1:100**
Drawn: **-** Checked: **-**

Dwg. No: **WF-010**

Rev: **B**

Announcements - Public Notices

Essex County Council

Department for Transport
Highways Act 1980 and Acquisition of Land
Act 1981

NOTICE is hereby given that Public Local Inquiries in connection with the Scheme and Orders mentioned below will be held by an Inspector appointed for the purpose by the Secretary of State for Transport beginning at 10.00am on Tuesday 11 June 2019 at Latton Bush Centre, Southern Way, Harlow CM18 7BL to hear representations from remaining objectors (as defined in the Compulsory Purchase (Inquiries Procedure) Rules 2007) and statutory objectors (as defined in the Highways (Inquiries Procedure) Rules 1994), from any other persons having an interest in the land the subject of the Compulsory Purchase Order and, at his discretion, to hear representations from any other persons who may desire to appear and be heard.

THE SCHEME and ORDERS are a Scheme and Orders which have been made by Highways England and Essex County Council under the above-mentioned Acts and submitted to the Secretary of State for Transport for confirmation and are:-

- (1) The Highways England Company Limited M11 Harlow North Junction (7A) (Slip Roads, Special Roads) Scheme 2018. This is a Scheme under sections 16, 17 and 19 of the Highways Act 1980.
- (2) The Essex County Council (Gilden Way/Sheering Road (B183) Improvement/Widening/Realignment, A1025 (New Link Road from B183 to M11) Scheme) (Classified Road) (Side Roads) Order 2018. This is an Order under sections 14 and 125 of the Highways Act 1980.
- (3) The Essex County Council (Gilden Way/Sheering Road (B183) Improvement/Widening/Realignment, A1025 (New Link Road from B183 to M11) and Grade Separated Junction/ Roundabouts at M11 Junction 7A Scheme) (Phase 1) Compulsory Purchase Order 2018. This is an Order under sections 239, 240, 242, 246 and 250(2) of the Highways Act 1980.

The Scheme and Orders relate to the highways which the Council propose to improve/construct from the B183 Gilden Way/Sheering Road, Harlow to, and including, the four new slip roads proposed to be constructed on the M11 at proposed Junction 7a, all in the parishes of Sheering and Matching in the District Authority of Epping Forest.

COPIES of the above-mentioned Scheme/Orders and of the plans referred to therein have been deposited and may be seen at all reasonable hours free of charge at the Central Library, Cross Street, Harlow, CM20 1HA and at the offices of Essex County Council, Council Offices, Chelmsford Library, Ground Floor, County Hall, Market Road, Chelmsford, CM1 1QH.

COPIES of any proofs of evidence, sent to or by the promoting authority are also available for inspection, at the offices of the Essex County Council from 21 May 2019.

PROCEEDINGS on the above-mentioned Scheme and Orders are being taken concurrently by virtue of Section 257 of the Highways Act 1980.

G Patrick, Department for Transport, Tyneside House, Skinnerburn Road, Newcastle upon Tyne NE4 7AR.
Ref: NATTRAN/E/LAO/168

Announcements - Public Notices

Notice of Application for a New Premises Licence under the Licensing Act 2003
Notice is given this day 18th May 2019 that Jialin Wei of [redacted] has applied to the Licensing office of Epping Forest District Council for a Premises Licence in respect of Wo Fat Restaurant of 270 -272 High Road Loughton Essex IG10 1RB. The proposed licence is for the following: The provision of recorded music - Monday to Saturday 12:00 - 14:30 and 17:00 - 00:00 and Sunday 12:00 -23:30. Late night refreshment - Monday to Saturday 23:00 - 00:00 and Sunday 23:00 -23:30, Supply of Alcohol - Monday to Saturday 12:00 - 14:30 and 17:00 - 00:00 and Sunday 12:00-23:30. Hours Premises Are Open To The Public - Monday to Saturday 12:00 - 14:30 and 17:00 - 00:00 and Sunday 12:00-23:30. Any representations regarding the above application should be made within 28 days of the day above, to; Epping Forest District Council, Licensing Unit Civic Offices, High Street, Epping, Essex CM16 4BZ.

Licensing Act 2003: Application for the Grant of a Premises Licence
Notice of application for the grant of a Premises Licence under section 17 of the Licensing Act 2003. Notice is hereby given that Mr Ylli Bokciu of 56 Cranbrook Road, Ilford Essex, IG1 4NF have made an application to the London Borough of Redbridge for the grant of a Premises Licence. The application is to permit the following: 1. Sale of alcohol consumed on the premises Sun-Wed 09:00 - 23:30, Thurs-Sat 09:00 - 00:00, 2. Late Night refreshments On and Off Premises: Sun - Wed 23:00 - 24:00, Thurs - Sat 23:00 - 24:30. Opening hours Sun 08:00- 24:00, Mon-Wed 06:00 - 24:00, Thurs-Sat 06:00 - 24:30. Representations must be made by 8th June 2019. Interested parties or responsible authorities wishing to oppose the application must give notice writing to: The London Borough of Redbridge, Licensing Service, 10th Floor, Lynton House, 255-259 High Road, Ilford Essex IG1 1NN. "IT IS AN OFFENCE, LIABLE ON CONVICTION TO A FINE UP TO LEVEL 5 ON THE STANDARD SCALE (£5,000), UNDER SECTION 158 OF THE LICENSING ACT 2003 TO MAKE A FALSE STATEMENT IN OR IN CONNECTION WITH THIS APPLICATION". The record of this application may be inspected Monday to Friday (except Bank Holidays) at the offices of The London Borough of Redbridge, Licensing Service, 10th Floor, Lynton House, 255-259 High Road, Ilford Essex IG1 1NN between the hours of 10:00am to noon and 2:00pm to 4:00 p.m, or on the Redbridge website at: <https://www.redbridge.gov.uk/business-and-regeneration/licensing-including-street-trading/alcohol-and-entertainment-licences/>

Licensing Act 2003: Application for the Grant of a Premises Licence
Notice of application for the grant of a Premises Licence under section 17 of the Licensing Act 2003. Notice is hereby given that Mr Paul Jellis has applied to the London Borough of Waltham Forest for the grant of a Premises Licence at: 76 High Street, Walthamstow E17 7LD. The nature of the application is to permit the following: Sale of alcohol consumed on & off the premises, recorded music (Indoors and outdoors), opening hours: 19:00-23:00 Mon-Thu, 19:00-00:00 Fri-Sat 11:00-23:00 Sun. Late Night refreshments on and off Premises: 23:00-00:00 Fri-Sat. Interested parties or responsible authorities can make written representations regarding this application and must give notice in writing to: The Licensing Section, Magistrates Building, 1 Farnan Avenue, London E17 4NX. Email - licensing@walthamforest.gov.uk, (Internet www.walthamforest.gov.uk). The date by which an interested party may make representations to the relevant licensing authority: 12th June 2019. This application and register held under the Licensing Act 2003 may be inspected during normal office hours at the above address. It is an offence to knowingly or recklessly make a false statement in connection with an application. A person is liable to an unlimited fine on conviction should such a false statement be made.

Announcements - Public Notices

JOY HILL (Deceased)
Pursuant to the Trustee Act 1925 any persons having a claim against or an interest in the Estate of the aforementioned deceased, late of 10 Lambourne Road Chapel Row Essex IG7 6ET who died on 04/03/2019, are required to send particulars thereof in writing to the undersigned on or before 26/07/2019, after which date the Estate will be distributed having regard only to claims and interests of which they have had notice.
CO-OP LEGAL SERVICES LIMITED
Aztec 650 Aztec West
Amorbysbury Bristol BS32 4SD
(Ref: DFOX4532604PH)

Something to say?



Do you have some news to share? It's never been easier.

Just visit guardian-series.co.uk/somethingtosay

If is th is pl

ASA.org

One partner providing you the solutions you need.

LOCALiQ is the way for you to reach customers as you've never been able to before, with the help of The Guardian Series. Our digital marketing experts can put together the bespoke campaigns that will help your business grow.

We'll harness the data we've gathered from our 218k+ unique browsers and 819k+ page views a month - and put it to work for you. Talk to us and you'll be drawing on the power of one of the world's largest tech and media companies. But you'll also be dealing with people who know Epping Forest as well as you do. After all, we've been part of your community for generations.

*Source, Ominture Q3 2018



Did you know we can reach up to **35%** of residents across core local markets.*

*Source: Telmar Nov 2018

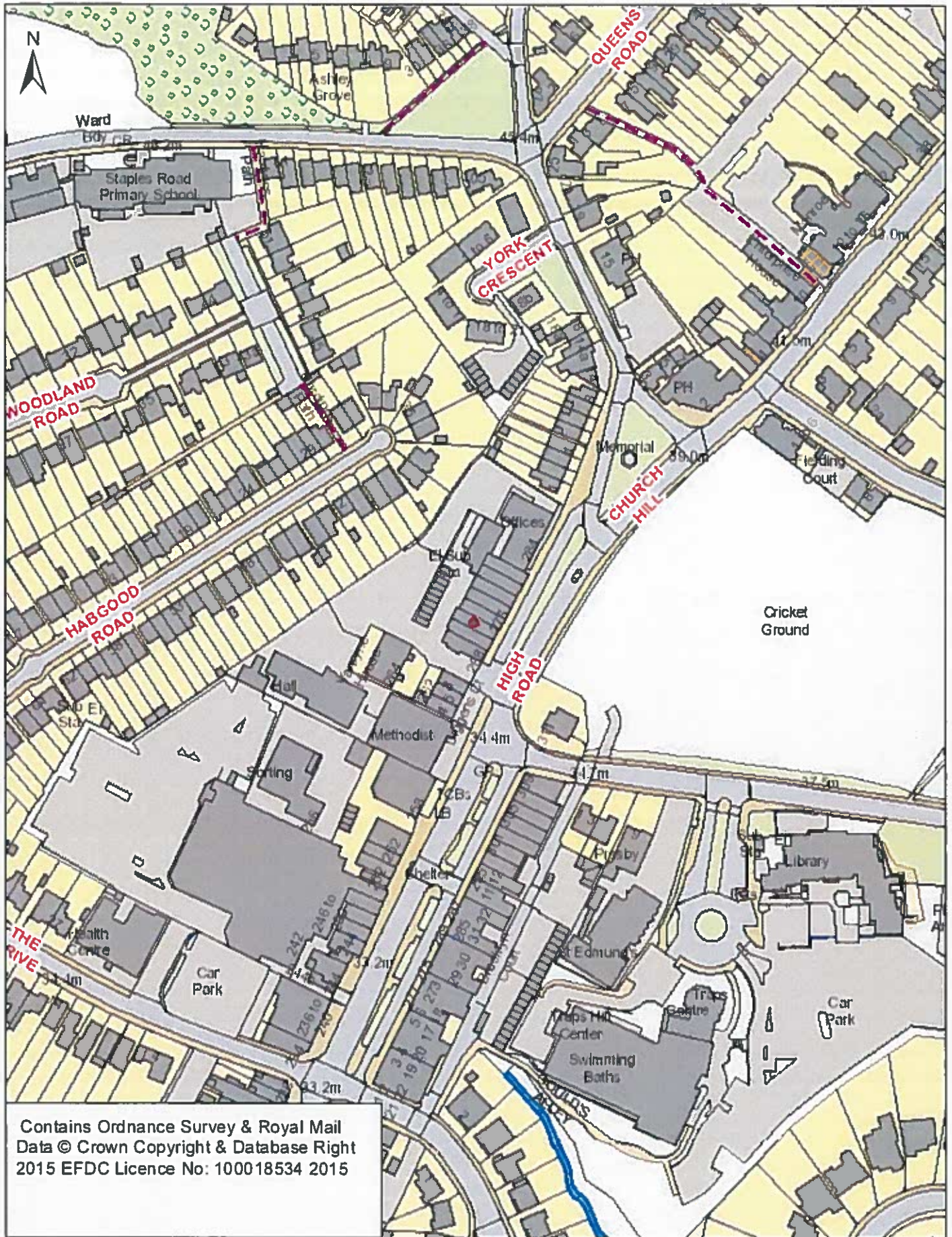

Notice of Application for a
New Premises Licence under the Licensing Act 2003

Notice is given this day 18th May 2019 that JIALIN WEI of

[REDACTED] has applied to the Licensing office of Epping Forest District Council for a Premises Licence in respect of Wo Fat Restaurant of 270-272 High Road Loughton Essex, IG10 1RB.

The proposed licence is for the following:

The provision of recorded music – Monday to Saturday 12:00 – 14:30 and 17:00 – 00:00 and Sunday 12:00 -23:30

Late night refreshment – Monday to Saturday 23:00 – 00:00 and Sunday 23:00 -23:30

Supply of Alcohol – Monday to Saturday 12:00 – 14:30 and 17:00 – 00:00 and Sunday 12:00 -23:30

Hours Premises Are Open To The Public – Monday to Saturday 12:00 – 14:30 and 17:00 – 00:00 and Sunday 12:00 -23:30

Any representations regarding the above application should be made within 28 days of the day above, to;

Epping Forest District Council
Licensing Unit Civic Offices,
High Street
Epping
Essex
CM16 4BZ

Denise Bastick

From: Licensing Epping and Brentwood
<licensing.epping.and.brentwood@essex.pnn.police.uk>
Sent: 11 June 2019 15:06
To: Licensing
Subject: Wo Fat, Loughton - Premises Licence Application - Objection
Attachments: Wo Fat - Objection.pdf; ATT00001.txt

Good Afternoon,

Please find attached Essex Police response to the application for a Premises Licence in respect of Wo Fat, 270-272, High Road, Loughton.

Could you confirm receipt and that you will pass this to all responsible authorities.

Kind regards,

Peter

Peter Jones (7706) MIOL, MBII

Essex Police Licensing Officer

Epping Forest | Harlow

Direct Tel. [REDACTED] Internal. [REDACTED]

Mob. [REDACTED] (only answered when on duty)



This email and any other accompanying document(s) contain information from Kent Police and/or Essex Police, which is confidential or privileged. The information is intended to be for the exclusive use of the individual(s) or bodies to whom it is addressed. The content, including any subsequent replies, could be disclosable if relating to a criminal investigation or civil proceedings. If you are not the intended recipient, be aware that any disclosure, copying, distribution or other use of the contents of this information is prohibited. If you have received this email in error, please notify us immediately by contacting the sender or telephoning Kent Police on 01622 690690 or Essex Police on 01245 491491, as appropriate. For further information regarding Kent Police's or Essex Police's use of personal data please go to <https://www.kent.police.uk/policy/privacy,-cookies-and-legal-notice/> or <https://www.essex.police.uk/copyright-privacy/>

Mrs K Tuckey
Licensing Department
Epping Forest District Council
Civic Offices
High Street
Epping
CM16 4BZ



Essex Police
Licensing Department
Braintree Police Station
Blyths Meadow
Braintree
CM7 3DJ
11th June 2019

Dear Mrs Tuckey,

OBJECTION TO APPLICATION FOR A PREMISES LICENCE (LICENSING ACT 2003)

Wo Fat, 270-272 High Road. Loughton, IG10 1RB is a Chinese restaurant which up until 18th March 2019 held a Premises Licence under the Licensing Act 2003 which was issued in 2005.

This Premises licence was revoked following a review applied for by Essex Police as a result of an immigration enforcement visit identifying seven illegal workers on the premises, and therefore undermining the prevention of crime and disorder licensing objective.

This application purports to be a new start with an applicant unconnected with how the premises has been run in recent years leading to an application for review in January 2019 – it is not. Essex Police have evidence that suggests those who were involved in the running of the business then; still have links to the premises.

Essex Police objects to this application under the crime and disorder objective, which includes the prevention of illegal working.

The previous Premises Licence Holder facilitated a criminal offence taking place. Essex Police believe there are clear associations between the old Premises Licence Holder and this applicant; and suggest the employment of illegal workers and failure to conduct right to work checks will continue.

It is the contention of Essex Police that this application is an attempt to allow the family to continue to run the premises. It is Essex Police's view that the employment of illegal workers (an undermining of the crime and disorder objective) will continue should this application be granted.

The Chief Officer of Police hereby objects to the proposed application and proposes to adduce further documentary and other material ahead of the hearing date in accordance with the statutory guidance and the relevant Hearing Regulations.

Please advise me of when the Licensing Panel will be meeting to hear this so representatives of the Chief Officer of Police can be in attendance.

Yours sincerely,

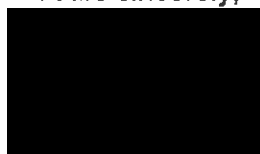

Mr Peter Jones MIOL, MBII
Essex Police Licensing Officer
Epping Forest | Harlow

Loughton Residents Association Plans Group



[REDACTED]
01 June 2019

[REDACTED]
Loughton,
Essex IG10 1AN

LICENSING APPLICATION, 270-272 High Road Loughton

This restaurant has residential units above and nearby. Indeed, with the exception of the relatively short Old Station Road, all the roads leading to and from the restaurant are residential, including the High Road, which has residential units above and behind the shops.

Under the provisions relating the prevention of public nuisance, we object to the proposal to vary the hours for the supply of alcohol and the provision of recorded music to midnight each night (11.30pm on Sundays) because of the disturbance this would inevitably cause to residents nearby.

We think that 11pm is the latest that restaurant with residential accommodation above should be providing alcohol and recorded music, as even if the premises are well-sound-proofed the noise of such customers - and their vehicles - leaving late at night, at a time when other daytime noises are much reduced, would obviously disturb residents.

Yours sincerely

[REDACTED]
David Linnell, for LRA Plans Group.

Denise Bastick

From: Judy Jennings [REDACTED]
Sent: 18 May 2019 13:36
To: Denise Bastick
Cc: Cllr Chris Pond; Jill Angold-Stephens
Subject: Re: New Premises Licence Application - Wo Fat, 270-272 High Road, Loughton, Essex, IG10 1RB

This Message originated outside of Epping Forest District Council.

Dear Denise

Thank you for the information

I do not have an objection to the licence application itself or the hours, or the Chinese Dragon event but I do have an objection to the "occasional live music" application which would be amplified, as I do not think it is appropriate for this area of flats and residential properties

Regards

Judy Jennings

Councillor Judy Jennings

Loughton St. Mary's - Epping Forest District Council

Regional Lead Peer - East of England and East Midlands - Local Government Association

From: Denise Bastick <dbastick@eppingforestdc.gov.uk>

Sent: 17 May 2019 14:30

To: [REDACTED]

Cc: Handan Ibrahim

Subject: New Premises Licence Application - Wo Fat, 270-272 High Road, Loughton, Essex, IG10 1RB

Good afternoon

Please find attached a new premises licence application for the above premises. The application is for a restaurant, the opening hours will be:

Monday to Saturday 12:00 – 14:30 and 17:00 – 00:00

Sunday 12:00 – 23:30

The licensable activities applied for are as follows:

Provision of Recorded Music

Monday to Saturday 12:00 – 14:30 and 17:00 – 00:00

Sunday 12:00 – 23:30

Late night refreshment

Monday to Saturday 23:00 – 00:00

Sunday 23:00 – 23:30

Supply of Alcohol:

Monday to Saturday 12:00 – 14:30 and 17:00 – 00:00

Sunday 12:00 – 23:30

The start date of the consultation is **18th May 2019**, end of consultation will be **14th June 2019**. Please let me have any comments or objections by then.

N.B. This is an unredacted copy and not for public consumption in this format, this will be available on the website shortly.

Kind Regards

Denise Bastick

Licensing Compliance Officer

dbastick@eppingforestdc.gov.uk

Tel: 01992 564334

Working hours Thursday – Friday

Please contact Mrs Handan Ibrahim, Licensing Compliance Officer

hibrahim@eppingforestdc.gov.uk Tel: 01992 564153

Monday – Wednesday



DISCLAIMER

This email is for the use of the intended recipients only. Any opinion or advice it contains is that of the sender and does not bind the authority in any way. If you have received it in error, please notify the sender immediately and then delete the message. If you are not the intended recipient you must not use, disclose, copy or distribute this email. We have taken precautions to minimise the risk of transmitting software viruses, but we advise that you carry out your own virus checks on an attachment to this message. We cannot accept liability for any loss or damage caused by software viruses.

Internet email is not a secure communication medium, and we advise that you observe this lack of security when emailing us.

Epping Forest District Council

Postmaster@Eppingforestdc.gov.uk